

Roberts Family

[Overview](#)

[Roberts Family -- Census, Birth, Death, Marriage Ancestry of William Roberts](#)

NOTE: Appendices contain supplemental information about the various peripheral family lines and/or locales – they add a little more color and detail to the main document.

[Appendix A ... Tithe & Apportionment – Cwm Celyn](#)

[Appendix B ... Cwm Celyn](#)

[Endnotes](#)

Roberts Family

Overview

Remember that the Roberts family connects with the Matthews family with the marriage of Jane Roberts to Walter Matthews.

1852. Marriage solemnized at <i>The Parish Church</i> in the <i>Parish</i> of <i>Llanover</i> in the County of <i>Monmouth</i>								
No.	When Married.	Name and Surname.	Age.	Condition.	Rank or Profession.	Residence at the Time of Marr.	Father's Name and Surname.	Rank or Profession of Father.
319	Nov 4 th 1850	Walter Matthews of full age & Jane Roberts of full age		Bachelor	Bailiff	Llanover	Richard Matthews	Farmer
				Spinster	—	Llanellen	William Roberts	Farmer
Married in the <i>Parish Church</i> according to the Rites and Ceremonies of the Established Church, by <i>Sicence</i> by me,								
This Marriage was solemnized between us,		<i>Walter Matthews</i>			in the Presence of us,		<i>William Roberts</i> <i>Mary Elizabeth Evans</i>	
		<i>Jane Roberts</i>					<i>John Evans, Vicar</i>	

The particulars are:

Nov 4th 1850, Parish Church of Llanover, Monmouth
 Walter Matthews of full age, bachelor, Bailiff, Llanover, Father = Richard Matthews, Farmer
 Jane Roberts of full age, Spinster, Llanellen, Father = William Roberts, Farmer
 Witnesses: William Roberts, Mary Elizabeth Evans



Photo of Llanover Church (dated 1898)¹

"LLANOVER, a parish in the upper division of the hundred of Abergavenny, county Monmouth, 4 miles S.E. of Abergavenny, its post town, and 7 from Pontypool. It is situated on the river Usk, near the Brecon canal. The parish includes the township of Blaenavon, where there are iron-works. The village is very considerable. The living is a vicarage* in the diocese of Llandaff, value £300, in the

Roberts Family – Monmouthshire Wales

patronage of the dean and chapter. The church is dedicated to St. Bartholomew. There is also the district church of Blaenavon, the living of which is a perpetual curacy,* value £114. The charities produce about £2, per annum. The Independents and Calvinistic Methodists have places of worship here. Llanover Court is the seat of Lord Llanover, who takes his title from this place. Lady Llanover supports a free school at her own expense; and there is another endowed by the late Mrs. Sarah Hopkins, with the interest of £3,000 government stock."

[Description(s) from *The National Gazetteer of Great Britain and Ireland* (1868)
Transcribed by Colin Hinson ©2003]ⁱⁱ

This family was fun to research as they have stayed on the same farm for generations, the farm has an interesting name and it seems to be in a beautiful location.

Roberts Family

We start with the census taken before Jane married Walter Matthews, as this gives us the fullest sense of the family.

1841 Censusⁱⁱⁱ ...

1	William Roberts	50		Farmer ✓	no	✓
	Elizabeth do	50			no	✓
	Henry do	23			y	
	William do	21			y	
	Eliza do	20			y	
	Jane do	16			y	
	Mary do	17			y	
	Ann do	15			y	

This is perfectly corroborated by these IGI entries

The IGI lists the following children all christened, Llanellen, Monmouth, with parents William Roberts and wife Elizabeth

Henry Roberts, christening 16 Mar 1818

William Roberts, christening 13 Feb 1820

Elizabeth Roberts, christening 30 Jun 1822

Jane Roberts, christening 22 Feb 1824

Mary Roberts, christening 3 Apr 1825

Anne Roberts, christening 7 Dec 1828

Martha Roberts, christening 7 Dec 1828, death 27 March 1829

Roberts Family – Monmouthshire Wales

Here is a map showing Llanellen^{iv} ...

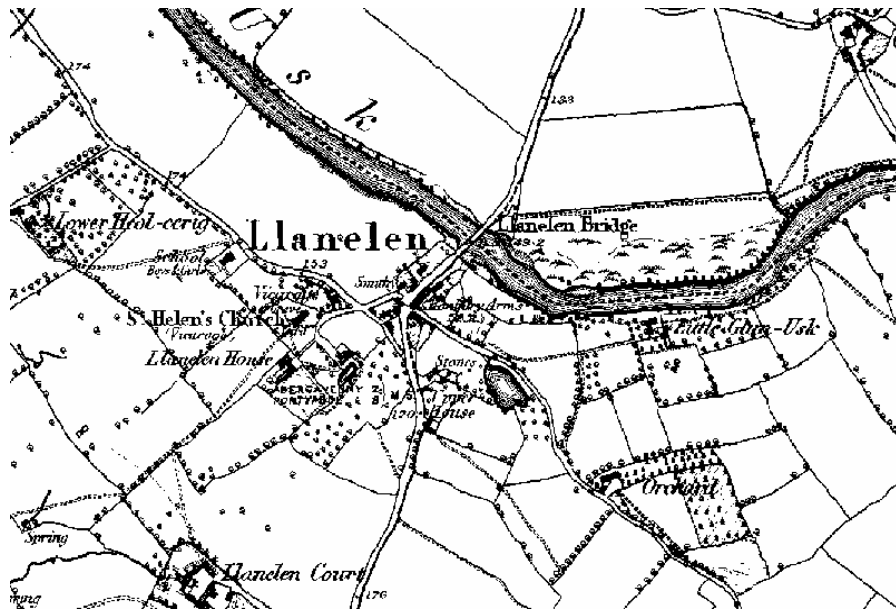

Photo of Llanellen Church (dated 1898) ... church where children were baptized^v

"LLANELLEN, a parish in the upper division of the hundred of Abergavenny, county Monmouth, 2 miles S. of Abergavenny, and 8 from Pontypool. It is situated on the western bank of the river Usk, and is crossed by the Brecon canal. It is a small agricultural village. The living is a vicarage in the diocese of Llandaff, value £105. The church is dedicated to St. Helen. The charities produce about £7 per annum."

[Description(s) from *The National Gazetteer of Great Britain and Ireland* (1868)
Transcribed by Colin Hinson ©2003]^{vi}

Roberts Family – Monmouthshire Wales



Modern photos of St. Helen, Llanellen (above) -- same person who took the photos of Cwm Celyn in Appendix B

Plans for St. Helen, Llanellen^{vii} (below)

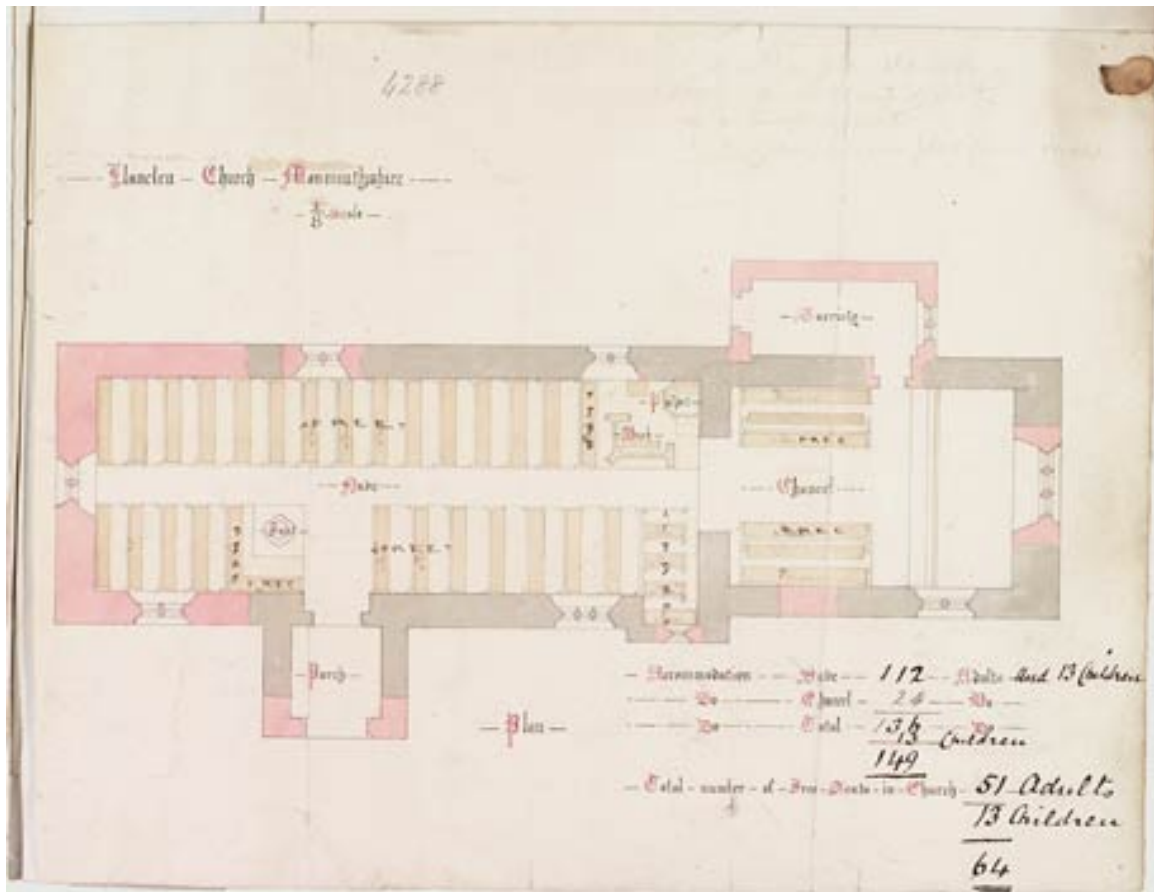

...

Roberts Family – Monmouthshire Wales

Tithe & Apportionment ...

A lister on the Yahoo Monfhs group (<http://groups.yahoo.com/group/monfh/>) was able to find some tithe maps and apportionment documents for Llanellen in the period 1836-1844 ... this spells out exactly what land the family was involved with, both acreage wise and via a map! See Appendix A for more about the tithe information.

1851 Census ...

Parish of <i>Llanellen</i>		Electoral District of		City or Borough of		Town of		Village of <i>410</i>	
Name of Street, Place, or Road, and Name or No. of House	Name and Surname of each Person who abode in the house, on the Night of the 30th March, 1851	Relation to Head of Family	Condition	Age of Male Persons	Rank, Profession, or Occupation	Where Born	Whether Married	Whether Single	Whether Widowed
<i>1st Corn Clyn</i>	<i>William Roberts</i>	<i>Head</i>	<i>Widr</i>	<i>60</i>	<i>Farmer</i>	<i>Glos Coates</i>			
	<i>Henry S^r</i>	<i>Son</i>	<i>W</i>	<i>33</i>	<i>Do</i>	<i>Llanellen</i>			
	<i>Jane Matthews</i>	<i>Daughter</i>	<i>M</i>	<i>27</i>	<i>Do</i>	<i>Llanellen</i>			
	<i>Walter Matthews</i>	<i>Son</i>	<i>M</i>	<i>25</i>	<i>Do</i>	<i>Monmouth</i>			
	<i>Jane Matthews</i>	<i>Serv</i>	<i>W</i>	<i>15</i>	<i>House Serv</i>	<i>Monmouthshire</i>			

1851 Census, Llanellen

William Roberts, M, W, 60, Farmer, Coates Glos
 Walter Matthews, M, M, 25, Farm Bailiff, Mon
 Jane Matthews, F, M, 27, Llanellen Mon
 Henry Roberts, M, S, 33, Farmer, Llanellen Mon

We see that wife Elizabeth has died. Unfortunately, between 1841 and 1851, there are at least 5 Elizabeth Roberts deaths listed for Abergavenny.

And, as one would expect, the daughters are no longer living at home and probably married. Unfortunately, Roberts was not an uncommon surname and their given names were also popular at the time – this makes it challenging to identify who and when they married.

1861 Census ...

<i>William Roberts</i>	<i>Head</i>	<i>Widr</i>	<i>71</i>	<i>Farmer</i>	<i>Gloucester Coates</i>
<i>Henry Roberts</i>	<i>Son</i>	<i>Mar</i>	<i>40</i>		<i>Monmouth Llanellen</i>
<i>Mary Lavinia Roberts</i>	<i>Daughter in Law</i>	<i>Mar</i>	<i>22</i>	<i>House Keeper</i>	<i>Gloucester Saint Brevils</i>
<i>Eliza Morgan</i>	<i>Serv</i>	<i>Un</i>	<i>12</i>	<i>Servant</i>	<i>Monmouth Blaenavon</i>

1861 Census, Llanellen, Cwm Farm

William Roberts, Widr, 71, Farmer, Coates Glos
 Henry Roberts, Mar, 40, Llanellen Mon
 Mary Lavinia Roberts, Daur in Law, 22, housekeeper, Gloucester Saint Brevils
 Eliza Morgan, Serv, un, 12, Monmouth Blaenavon

Daughter Jane and husband Walter Matthews have moved to the Matthews farm in nearby Bassaleg ... see the Matthews write-up for the details on this farm.

Roberts Family – Monmouthshire Wales

NOTE: this is when we first found mention of the farm name and eventually realized it was called Cwm Celyn Farm and that is how it is labeled on the maps from the late 1800s – for much more information on the farm, see Appendix B. Subsequently, a look at the actual 1851 census entry revealed the farm name also. – we initially worked from an index.

We find that William dies in 1871 in advance of the 1871 Census:

Llanellen MIs^{viii} -- William Roberts died 8.2.1871 aged BLANK

Corroborated by (FreeBMD)^{ix}:

Deaths Mar 1871

Roberts William 82 Abergavenny 11a 40

Though, we still find him in this Directory listing for 1871^x ... not unusual due to the time lag involved in publishing a directory. You will notice that his son William, the butcher, is also listed.

LLANELLEN is a parish and small village, 2 miles south from Abergavenny railway station, in Pontypool hundred, union and county court district of Abergavenny, Abergavenny rural deanery, Monmouth archdeaconry, Llandaff diocese, and Canterbury province. : it is situated on the road from Abergavenny to Pontypool. The parish is bounded on the east and north by the river Usk, over which is a stone bridge of three arches. The Monmouthshire Canal runs through from north to south. The church of St. Helen is a Gothic stone building, repaired in 1840: it has nave, chancel, and turret, with 2 bells. The register dates from about the year 1760. The living is a vicarage, value £132, with residence, in the gift of Colonel Kemeys-Tynte, and held by the Rev. William Jones. There

is a National school for boys and girls. Here is a quarry; the stone is used for building purposes. A part of the Bloreng Mountain is within this parish. The Earl of Abergavenny and Colonel Kemeys-Tynte are lords of the manor, and these, with Mr. J. T. Wilson, are the principal landowners. The soil is loamy; subsoil, stone. The chief crops are wheat, oats, barley, with some land in pasture. The area is 2,536 acres; gross estimated rental, £2,191; rateable value, £1,925; and the population in 1861 was 373.

Letters through Abergavenny, which is the nearest money order office
National School, Miss Mary Jane Wheeler, mistress

Jones William, farmer, Upper Heol Gwyr farm	Perry William, farmer, Little Glan-Usk	Probert Thomas, farmer, Duŵryn
Jones William, farmer, Pant farm	Phillips John, blacksmith	Prosser Henry, Miller, Ogran mill
Michael John, auctioneer, Baily-glas	Powell James, carpenter	Roberts William, butcher, Twygo glas
Morgan Peter, farmer, Court farm	Powell William, farmer, Spltry farm	Roberts William, farmer, Cwm Celin
Morgan Roger, farmer, Green court	Powell William, flombery Arms	Sheddick Charles, farmer, Tyr Air
	Price Daniel, mkt gardnr. The Orchards	Tedman Eli, farmer, Ty-gwyn

Now the family farm is in the hands of son Henry ...

1871 Census -- basically, son Henry now has the farm and has 3 children – Mary Eliza, William Henry, Sarah Ann and it looks like his brother William Roberts also stayed in town and became a Butcher (consistent with directory listing above)!

Cwm Celyn	1.	Henry Roberts	Head	Mar.	52	Farmer.
"	"	Mary Eliza	Wife	"	32	"
"	"	Mary Eliza	Daughter	Unm.	11	Scholar.
"	"	William Henry	Son	"	8	"
"	"	Sarah Ann	Daughter	"	3	"
"	"	Ruth Harriet	Serv.	"	18	Dom. Serv.

1881 Census -- son Henry still has the farm and has one more daughter, Hester Dora Roberts & brother William is still a butcher in town.

Roberts Family – Monmouthshire Wales

<i>Henry Roberts</i>	1	<i>Henry Roberts</i>	Head	Mar	59	<i>Farmer (57 ac) (1 man)</i>
<i>Mary Olivia Roberts</i>		<i>Mary Olivia Roberts</i>	Wife	Mar	44	<i>Farmer's Wife</i>
<i>Mary Elizabeth Roberts</i>		<i>Mary Elizabeth Roberts</i>	Daughter	Unm	19	<i>Dressmaker</i>
<i>William Henry Roberts</i>		<i>William Henry Roberts</i>	Son	Unm	17	<i>Farmer's Son</i>
<i>Sarah Ann Roberts</i>		<i>Sarah Ann Roberts</i>	Daughter	Unm	13	<i>Scholar</i>
<i>Hester Dora Roberts</i>		<i>Hester Dora Roberts</i>	Daughter	Unm	9	<i>Scholar</i>
<i>Henry Jacob</i>		<i>Henry Jacob</i>	Servant	Unm	24	<i>Farm Servant Indoors</i>

1881 Census^{xi}

Name Relation Marital Status Gender Age Birthplace Occupation Disability
 Henry ROBERTS Head W Male 59 Lanellen, Monmouth, England Farmer (57 Ac) (1 Man)
 Mary Olivia ROBERTS Wife M Female 44 Gloucester, England Farmers Wife
 Mary Elizabeth ROBERTS Daughter U Female 19 Lanellen, Monmouth, England Dressmaker
 William Henry ROBERTS Son Male 17 Lanellen, Monmouth, England Farmers Son
 Sarah Ann ROBERTS Daughter Female 13 Lanellen, Monmouth, England Scholar
 Hester Dora ROBERTS Daughter Female 9 Lanellen, Monmouth, England Scholar
 Henry JACOB Servant U Male 24 Lanellen, Monmouth, England Farm Servant Indoors

It was also found in the Llanellen MI's^{xii}, 2 graves next to each other

Henry Roberts of Abergavenny died 9.12.1884 aged 66
 Mary Olivia Roberts w/o above died 9.3.1886 aged 47

Which is consistent with what FREEBMD gives ...

Deaths Dec 1884

 Roberts Henry 63 Abergavenny 11a 38

Deaths Mar 1886

 ROBERTS Alfred David 0 Abergavenny 11a 37
 ROBERTS Olivia 46 Abergavenny 11a 42

So, by 1891^{xiii} the farm in the hands of William Roberts, grandson of William Roberts where we started!

<i>John Jenkins</i>	1	<i>William Roberts</i>	Head	Mar	47	<i>Farmer</i>
<i>Sarah Ann</i>		<i>Sarah Ann</i>	Sister	Mar	43	
<i>Dora</i>		<i>Dora</i>	Sister	Mar	19	
<i>Tom Jenkins</i>		<i>Tom Jenkins</i>	Son	Mar	16	

Roberts Family – Monmouthshire Wales

And in 1901^{xiv} he is still working the farm as reported in the Census and also the Kelly's Directory of Monmouthshire, 1901^{xv}

1		2 HOUSES				3		4		5		6		7		8		9		10		11		12		13		14	
No. of	ROAD, STREET, No. and No. of NAME of HOUSE	Occupied	Unoccupied	Number of Rooms	Number of Cottages	Name and Surname of each Person	RELATION to Head of Family	Sex	Age last Birthday of	Profession or Occupation	Employer, Worker, or Own account	Married	Widowed	Single	Divorced	Age last Birthday of	Profession or Occupation	Employer, Worker, or Own account	Married	Widowed	Single	Divorced	Age last Birthday of	Profession or Occupation	Employer, Worker, or Own account	Married	Widowed	Single	Divorced
50	Cwm Celyn	1				Wm. H. Roberts	Head	M	37	Farmer	Employer																		
						Jane Roberts	Wife	F	39																				
						William R. Roberts	Son	M	5	Scholar																			
						Bernard H. Roberts	Son	M	4																				
						Erica S. Roberts	Daughter	F	2																				
						Charles H. Roberts	Servant	M	72	Agricultural Labourer	Worker																		
						Arthur James	Servant	M	16	Agricultural Labourer	Worker																		

Llanellen
Commercial
Roberts Wm., farmer, Cwm-Celin

Coming forward, we had heard that the family still farmed Cwm Celyn and using 192.com Directory service (UK) ... we found and confirmed with others that this is a direct descendent of William Roberts ...

W.H. Roberts
Willingham
Llanellen
Abergavenny
Gwent
NP7 9LD

We are attempting to communicate with this distant relative.

Ancestry of William Roberts

Mike John^{xvi}, who manages a Monmouthshire Newsgroup (via Yahoo) created this family tree for the Roberts family using the IGI, Gloucestershire marriage records and other sources ... the blue highlight shows Jane and husband Walter Matthews and the green highlight shows the other family members living together for the 1841 census

Descendants of Henry Roberts

1 Henry Roberts

. +Jane

..... 2 Amy Roberts b: 1782 Coates, Gos.

..... +John Allen b: Abt. 1790 Sapperton, Gos. m: 12.11.1809 Coates, Gos.

..... 2 John Roberts b: 1783 Coates, Gos.

..... 2 Hester Roberts b: 1784 Coates, Gos.

..... 2 Joseph Roberts b: 1786 Coates, Gos.

..... +Rebecca Savage b: Abt. 1796 Malmesbury, Wilts m: 21.11.1815 Coates, Gos.

..... 2 Ann Roberts b: 1787 Coates, Gos.

..... +James Marchant m: 30.08.1807 Coates, Gos.

..... 2 Hester Barber Jones Roberts b: 1789 Coates, Gos.

..... 2 William Roberts b: 1789 Coates, Gos. Farmer.

..... +Elizabeth Tyler m: 20.05.1817 Newland, ~~Mon.~~ Gos (my update)

..... 3 Henry Roberts b: 1818 Llanellen, Mon.

..... +Martha Lavinia b: Abt. 1838 St Briavels, Gos.

..... 4 Mary Elizabeth Roberts b: 1859 Llanellen, Mon.

..... 4 William Henry Roberts b: 1862 Llanellen, Mon.

..... 4 Sarah Roberts b: 1867 Llanellen, Mon.

..... 4 Hester Dora b: 1872 Llanellen, Mon. (my addition)

..... 3 William Roberts b: 1820 Llanellen, Mon. Butcher.

..... +Jane b: Abt. 1825 Llanddewi Rhydderch, Mon.

Roberts Family – Monmouthshire Wales

..... 4 Thomas Roberts b: 1846 Llanellen, Mon.
 4 William Roberts b: 1851 Llanellen, Mon.
 4 George Roberts b: 1856 Llanellen, Mon.
 4 Elizabeth Roberts b: 1859 Llanellen, Mon.
 4 Eleanor Jane Roberts b: 1864 Llanellen, Mon.
 4 Louisa Roberts b: 1866 Llanellen, Mon.

..... 3 Elizabeth Roberts b: 1822 Llanellen, Mon.

..... 3 Jane Roberts b: 1824 Llanellen, Mon.

..... +Walter Matthews b: 1825 Bassaleg, Mon.

..... 3 Mary Roberts b: 1825 Llanellen, Mon.

..... 3 Anne Roberts b: 1828 Llanellen, Mon.

..... 3 Martha Roberts b: 1828 Llanellen, Mon.

..... 2 Henry Roberts b: 1794 Coates, Gos.

Burial Date	Forename	Surname	Age	County	Place / Details
14 Feb 1813	Thomas	ROBERTS	20	Gloucestershire	Coates, St Matthew
23 Dec 1813	Hester	ROBERTS	80	Gloucestershire	Coates, St Matthew
8 Sep 1822	Mary Ann	ROBERTS	11m	Gloucestershire	Coates, St Matthew
1 May 1825	Jane	ROBERTS	70	Gloucestershire	Coates, St Matthew
10 Apr 1827	Fanny	ROBERTS	39	Gloucestershire	Coates, St Matthew
9 Mar 1828	Joseph	ROBERTS	11m	Gloucestershire	Coates, St Matthew
8 May 1836	Joseph	ROBERTS	50	Gloucestershire	Coates, St Matthew
14 May 1837	Selina	ROBERTS	6m	Gloucestershire	Coates, St Matthew
20 Dec 1837	Maria	ROBERTS	5	Gloucestershire	Coates, St Matthew
31 May 1844	Eliza	ROBERTS	23	Gloucestershire	Coates, St Matthew
10 Nov 1846	Richard	ROBERTS	74	Gloucestershire	Coates, St Matthew
23 Apr 1848	Eliza Bella	ROBERTS	9m	Gloucestershire	Coates, St Matthew
5 Jul 1849	William Thomas	ROBERTS	5m	Gloucestershire	Coates, St Matthew

Above are what The National Burial Index (NBI) has for Roberts burials in Coates ...

Roberts Family – Monmouthshire Wales

- >> Jane is probably the wife of the patriarch Henry ... this would make her birth date c. 1755
- >> One wonders if Hester, is the mother of Henry as her birth date would be c. 1733
- >> Joseph (the elder) is the son Joseph born in 1786



The pictures above are of St. Matthews, Coates^{xvii} ... it has many beautiful stain glass panels.



For the Tyler connection -- from what we can tell, Newland is on the Gloucester – Monmouth border. If you look at the map below, we believe that the heavily dotted line to the left of the image is the border between Gloucester (to the right) and Monmouth (to the left). Pictured to the left “might” be the church the Tyler family was associated with, All Saints Church, Newland (Gloucester).^{xviii}

Newland is considered part of “The Forest of Dean.”

Besides Elizabeth Tyler marrying in Newland, we find several other Tyler individuals marrying here also ... these could be siblings or other relatives of Elizabeth ...

Roberts Family – Monmouthshire Wales

unfortunately, no baptisms or marriages appear to be listed for Newland during this same time period.

1. [PETER TYLER](#) - International Genealogical Index
Gender: Male Marriage: 13 JUN 1838 Newland, Gloucester, England
2. [MARGARET TYLER](#) - International Genealogical Index
Gender: Female Marriage: 24 JAN 1839 Newland, Gloucester, England
3. [CHARLES TYLER](#) - International Genealogical Index
Gender: Male Marriage: 30 SEP 1838 Newland, Gloucester, England
4. [MARGARET TYLER](#) - International Genealogical Index
Gender: Female Marriage: 13 FEB 1765 Newland, Gloucester, England
5. [WILLIAM TYLER](#) - International Genealogical Index
Gender: Male Marriage: 25 APR 1839 Newland, Gloucester, England
6. [ANN TYLER](#) - International Genealogical Index
Gender: Female Marriage: 24 DEC 1831 Newland, Gloucester, England
7. [ELEANOR TYLER](#) - International Genealogical Index
Gender: Female Marriage: 01 APR 1771 Newland, Gloucester, England
8. [ELIZABETH TYLER](#) - International Genealogical Index
Gender: Female Marriage: 31 MAR 1766 Newland, Gloucester, England
9. [THOMAS TYLER](#) - International Genealogical Index
Gender: Male Marriage: 19 JUL 1812 Newland, Gloucester, England
10. [MARY TYLER](#) - International Genealogical Index
Gender: Female Marriage: 05 FEB 1810 Newland, Gloucester, England
11. [ELIZABETH TYLER](#) - International Genealogical Index
Gender: Female Marriage: 20 MAY 1817 Newland, Gloucester, England
12. [MARY TYLER](#) - International Genealogical Index
Gender: Female Marriage: 19 NOV 1825 Newland, Gloucester, England
13. [JOHN TYLER](#) - International Genealogical Index
Gender: Male Marriage: 16 APR 1817 Newland, Gloucester, England
14. [JAMES TILER](#) - International Genealogical Index
Gender: Male Marriage: 01 DEC 1807 Newland, Gloucester, England
15. [JAMES TYLER](#) - International Genealogical Index
Gender: Male Marriage: 04 JUL 1836 Newland, Gloucester, England
16. [PRUDENCE TYLER](#) - International Genealogical Index
Gender: Female Marriage: 18 JUN 1776 Newland, Gloucester, England

And the NBI lists these who could possibly be siblings or their families and no one is really quite old enough to be the parents ... unless Margrett is her mother?

Burial Date	Forename	Surname	Age	County	Place / Details
8 Jul 1822	Margrett	TYLER	45	Gloucestershire	Newland, All Saints
12 Jul 1823	Silvia	TYLER	40	Gloucestershire	Newland, All Saints
20 Aug 1823	Sarah Anne	TYLER	4m	Gloucestershire	Newland, All Saints
7 Jul 1838	Susannah	TYLER	19m	Gloucestershire	Newland, All Saints
18 Jan 1841	Thomas	TYLER	4m	Gloucestershire	Newland, All Saints
1 Feb 1842	Charles	TYLER	2	Gloucestershire	Newland, All Saints
15 Dec 1842	James	TYLER	14d	Gloucestershire	Newland, All Saints

Roberts Family – Monmouthshire Wales

18 Apr 1846	Tom	TYLER	11m	Gloucestershire	Newland, All Saints
13 Mar 1847	Sophia	TYLER	7	Gloucestershire	Newland, All Saints
6 Sep 1849	John	TYLER	2+	Gloucestershire	Newland, All Saints
11 Oct 1851	Thomas	TYLER	60	Gloucestershire	Newland, All Saints

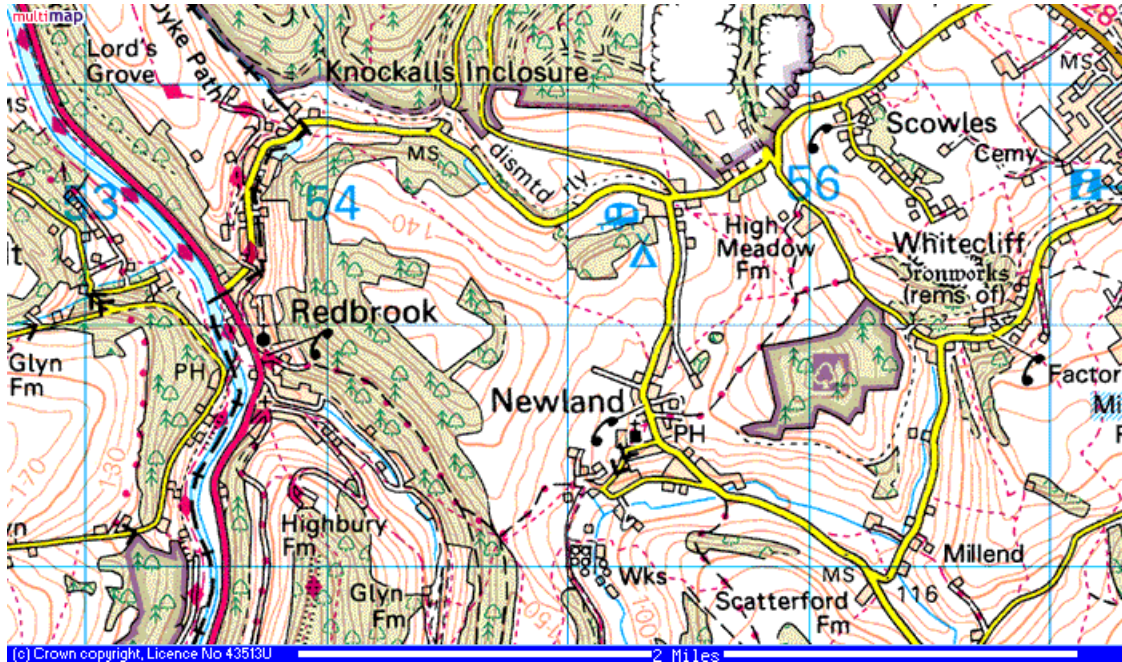

Doing a quick scan of the 1851 census^{xix} for Coates Gloucestershire for Roberts ... we find the widow of Joseph Roberts still living in Coates and nothing more ...

17

ROBERTS Rebecca Widow 54 Former Lace Maker Malmesbury
 James 27 Ag Lab Coates
 John 21 Ag Lab Coates
 Joseph 15 Ag Lab Coates

Coates is in Central Gloucestershire, near the blue triangle on the map^{xx} below.

Roberts Family – Monmouthshire Wales

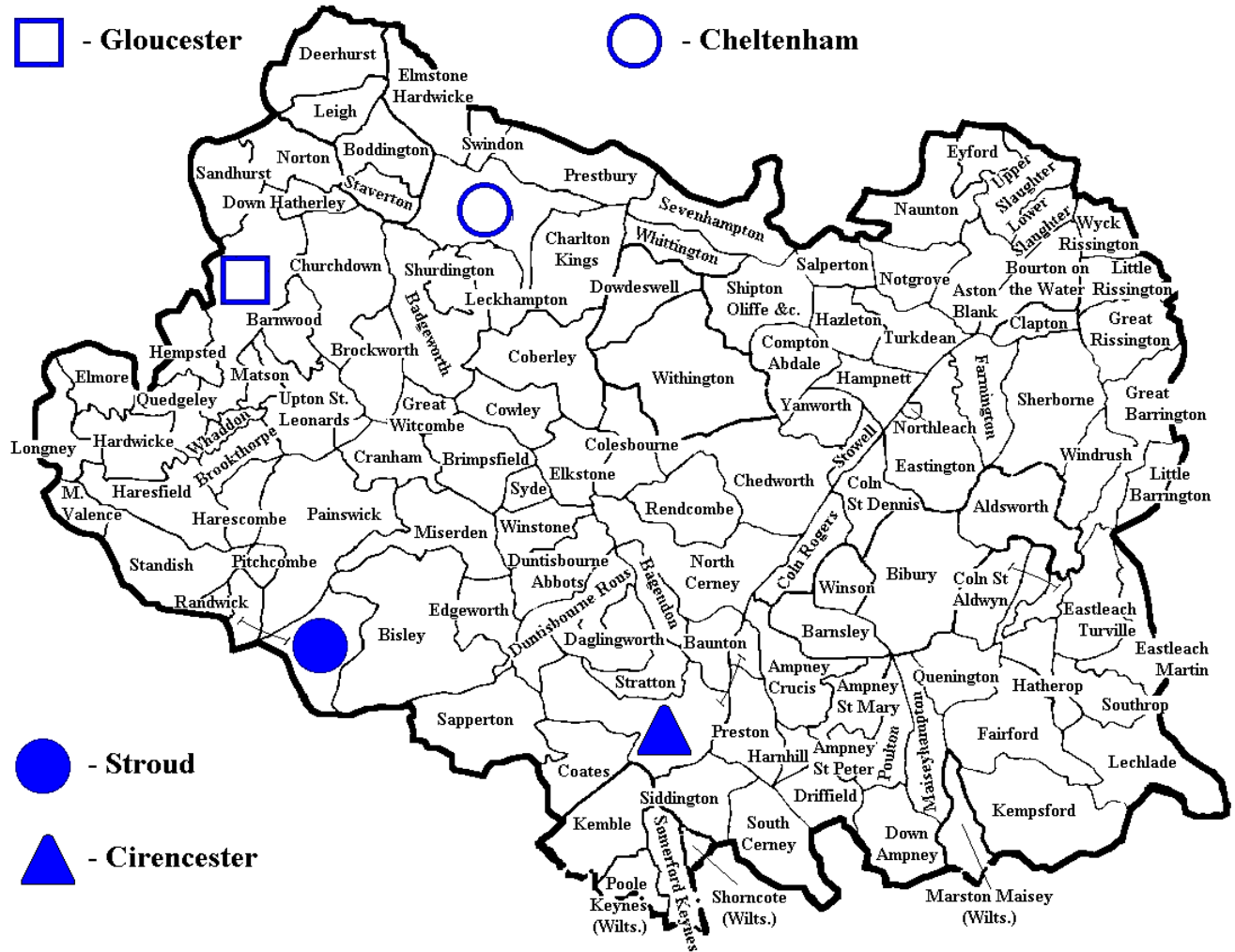

Unless we access the parish records filmed by the LDS church or do some more in-depth research ... we will know little of the Roberts family and its association with Coates.

Appendix A
Tithe and Apportionment – Cwym Celyn

“Tithes were traditionally a tax of one tenth of the produce of land, designed to support the church and clergy. In 1836 the Tithe Commutation Act provided for the substitution of an annual tithe rent charge. The collection of tithes (and the extortionate practices of individual tithe owners) caused great anger in an era of economic depression and religious dissent. Tithe maps of parishes were drawn up to apportion responsibility for payment and these maps are amongst the earliest highly detailed maps of Wales.”^{xxi}

The National Library of Wales (<http://www.llgc.org.uk/>) has more information on what Tithe maps are, how they came into being and other elements of their history.

At this time, William Roberts was responsible for a fair amount of farm land ... a mix of “Charity Land of Llanellan” and “Mary Jones land” and “Reece Williams land”

Charity Land of Llanellan	William Roberts	293	Arable	2	55	1	.
		294	House & garden		26		6
		403	Pasture	1	20	2	.
		404	Pasture	2	20	3	.
		405	Pasture	1	3	0	10

Note that this property had Arable Land, A house & Garden and Pasture.

LANDOWNERS	OCCUPIERS	Numbers referring to the Plan.	NAME AND DESCRIPTION OF LANDS AND PREMISES	STATE OF CULTIVATION	QUANTITIES IN STATUTE MEASURE	PAYABLE TO	
						Tithe	Improvement
mes Mary (cont #1)	William Roberts	259	Arable	1	2 26	2	1
		260	Arable	2	54	2	9
		262	Pasture	1	27	2	8
		263	Pasture	2	16	1	2
		264	Pasture	3	24	1	10
		265	House & garden		32		6
		268	Arable	2	6		8
		269	Pasture	1	2 19	3	2
					9 - 29	14	10

Note that this property had Arable Land, Pasture and Another house & Garden.

Williams Reece	William Roberts	313	Brake	7	3 24	3	.
		316	Pasture	1	1 26	2	6
		317	Arable	2	3 39	3	9
		318	Pasture	2	3 35	3	10
		319	Brake	6	3 21	2	6
		320	Pasture	1	3 35	1	10
		323	Pasture	3	22	5	6
		323a	Brake		35		1
		323	Pasture	2	20	3	.
		324	Brake		30		1
		327	Arable	2	2 35	3	6
		328	Arable	3	3 22	4	11
		328	Arable	2	3 11	3	6
		327	Arable	2	2 38	3	6
		329	Orchard	2	3 14	2	3
		329	House & garden	1	12		9
		328	Orchard	1	22	1	1
321	Pasture	3	38	1	6		
322	Pasture	1	5		7		
323	Orchard	3	28	6	9		
			146	3 32	2 16	5 19 2	

Roberts Family – Monmouthshire Wales

Note that this property had Arable Land, Pasture, some orchards, another House & garden and land referred to as “Brake.”

Looking approximately North, this would be the layout of the lands “occupied” by William Roberts ... we have color-coded them to coincide with the color scheme of the land owner as indicated previously.

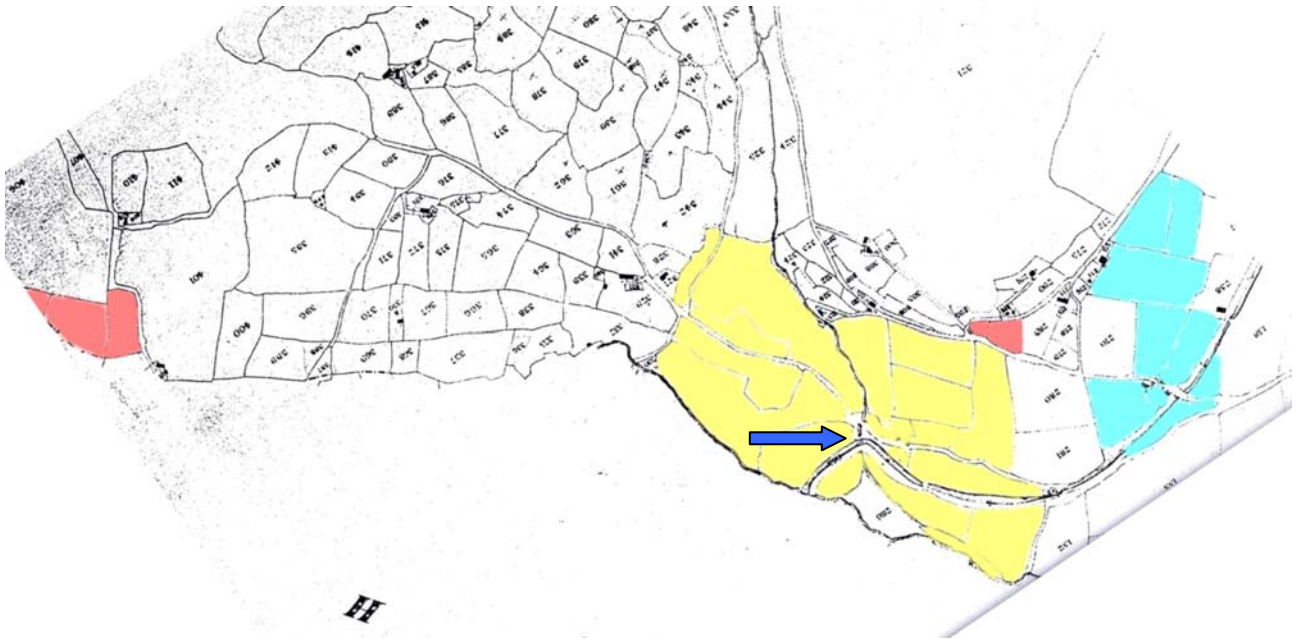

When you look at the location Maps for Cwm Celyn in the next section, you will see how the turn in the canal matches up on both of these maps, though the overall orientation of both maps is not quite the same ... so, match up the blue arrows to orient yourself.

Note: The original copies were provided by: Mike John, Moderator, Yahoo Monmouthshire Newsgroup, <http://groups.yahoo.com/group/monfh/>, mdjohn@ntlworld.com as obtained from the National Library of Wales.

Appendix B
Cwm Celyn

Several Welsh speaking individuals have stated that the farm name is: "Cwm-celyn" which is valley – holly. Though, we have seen ... Cwm Celin and the 1861 census says Cwm farm and the 1871 census states Cwm Kylan (sp?) and the 1881 census states Cwm Coulan ... so, name variants abound!!!

(ref: www.old-maps.co.uk)

County: MONMOUTHSHIRE	Date : 1886	Grid Ref: 329859,209232
--	--------------------	--------------------------------

Here is the close-up detail of the farm and then the next map shows the farm in perspective to Llanellen! Can't get the scale on the old map to show the relative location and so a modern map is used ... Find Llanellen near the top and then go south and look for the distinctive curve in the canal -- the farm sat on the northern side of the curve (essentially off of Oak Lane)!

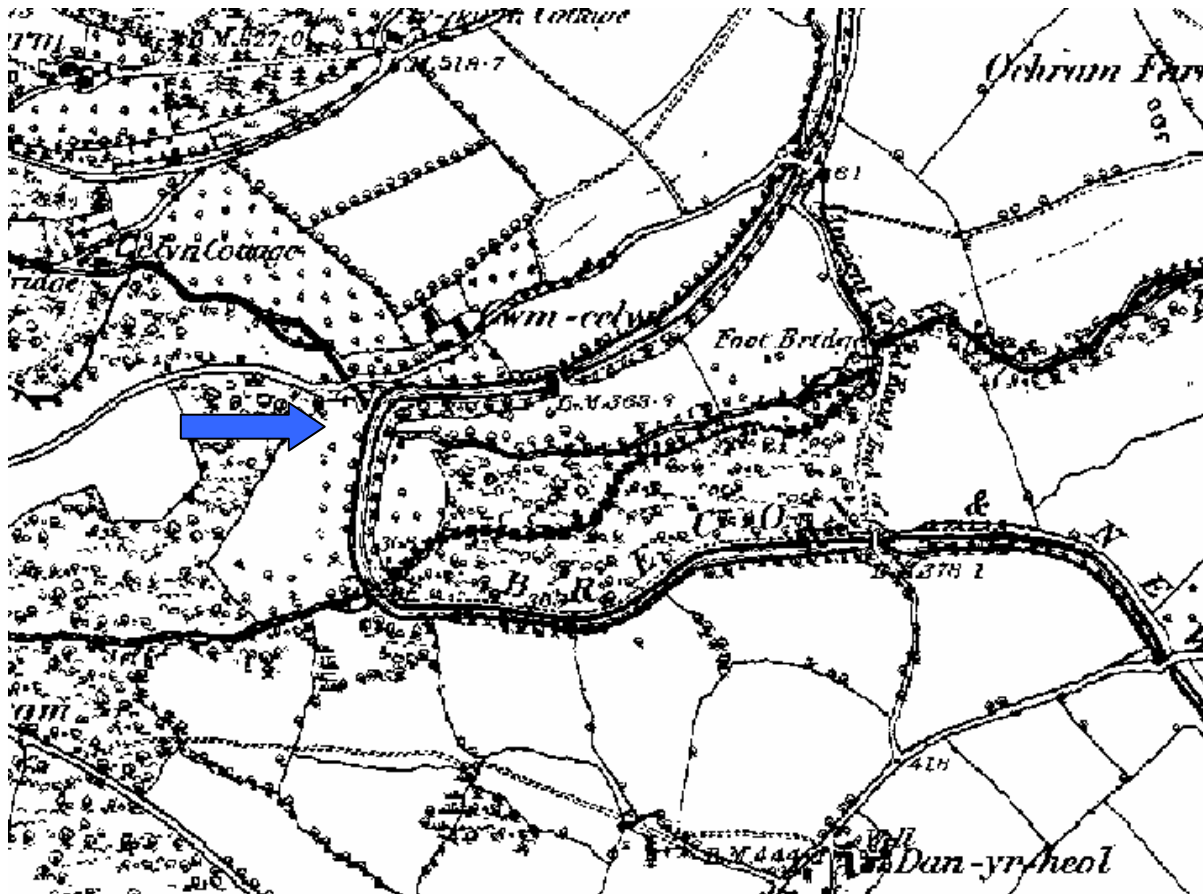

Roberts Family – Monmouthshire Wales

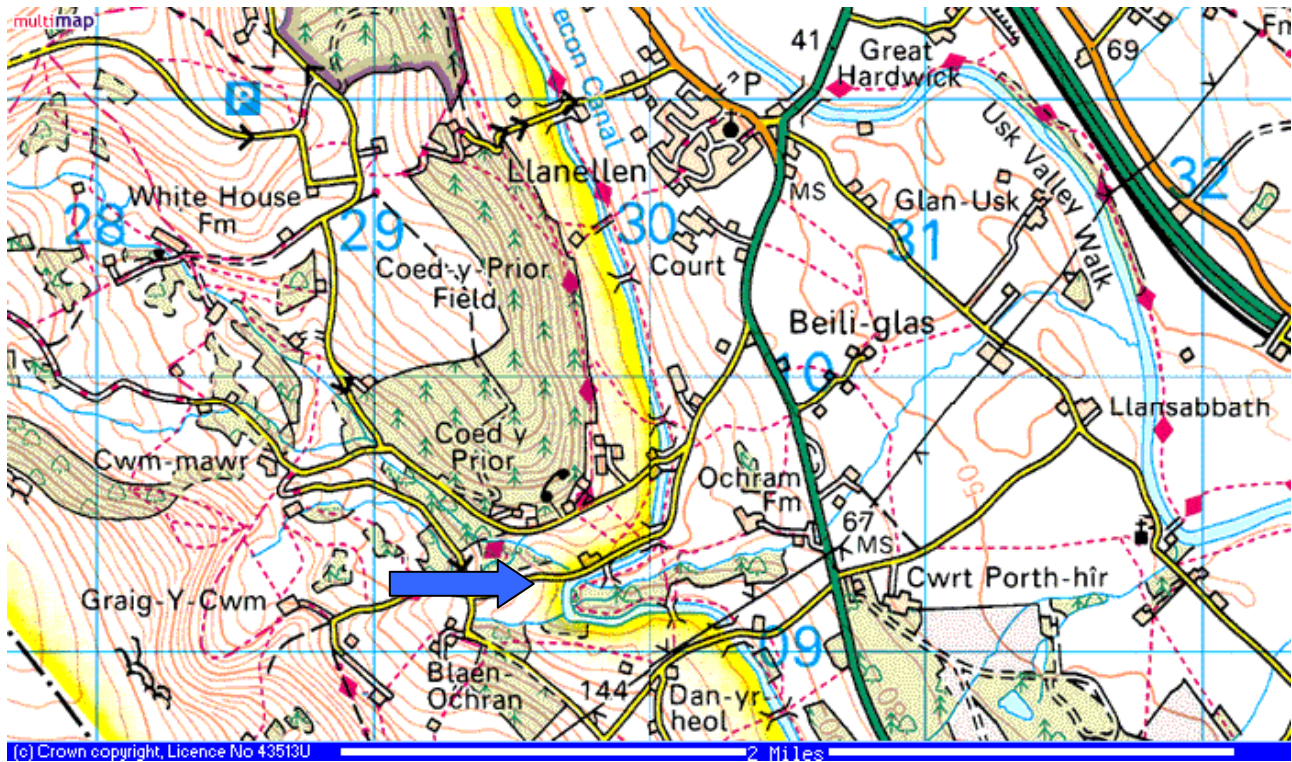

From a lister:

“A very long shot I know but a family of Roberts lived as long as I can remember at a farm which would be classed as Llanellen.

If you travel out of Abergavenny and go on the A 4042 Pontypool Road it will bring you to Llanellen this is about 2-3 miles outside Abergavenny. If you pass through Llanellen on this road, after half a mile turn right at an angle, up Oak Lane an unclassified lane (this can eventually take you up to Blaenavon). Go up that lane and immediately after you go over a bridge on the Monmouthshire to Brecon Canal, the farm is on your left, Maybe worth checking on a map?”

This did end up being the farm and the directions got us the maps you see above!

>> the canal, the Brecon & Abergavenny Canal, that ran right by their farm is discussed in much detail at these sites ... <http://www.mon-brec-canal-trust.org.uk/index.htm> & <http://easyweb.easynet.co.uk/jim.shed/Monmouthshire--Brecon-Canal.html#B&AC> & <http://history.powys.org.uk/school1/brecon/canmenu.shtml>

We have learned that the family still farms and thanks to the help of a wonderful person

Phil Hughes

Honorary Secretary

Monmouthshire, Brecon & Abergavenny Canals Trust Ltd.

Reg. Office:-Laurel House, 95 The Highway

New Inn, Pontypool, Torfaen, NP4 0PN

Tel:-01495 762823 or 07971 235182

www.mon-brec-canal-trust.org.uk

Charity no. 515879

We have some wonderful photos of the farm ...



END NOTES

ⁱ Frith Photos, Llanover,

<http://www.frithphotos.com/pageloader.asp?page=/info/productselector.asp&neg=41686&collectionid=10&townid=52044&start=1&action=prevphoto>

ⁱⁱ <http://www.genuki.org.uk/big/wal/MON/Llanover/>

ⁱⁱⁱ e-mail received 29 July 2005, from Mike John, mike john [mdjohn@ntlworld.com], 1841 Census, Llanellen

^{iv} www.old-maps.com, Monmouthshire, 1886, Grid Ref: 330539,210911

^v

<http://www.frithphotos.com/pageloader.asp?partner=us&page=/search/placeLander.asp&location=Llanellen&county=gwent> – not sure if this is the church ... can also find one's labeled Llanellen ... same or different place?

^{vi} <http://www.genuki.org.uk/big/wal/MON/Llanellen/>

^{vii} www.churchplansonline.org, **LLANELEN, St. Helen (1850-1851)**, LLANELEN, groundplan created by ?PRICHARD, John: b. 1817 - d. 1886 of London and Llandaff

^{viii} Monmouth Yahoo Newsgroup, <http://groups.yahoo.com/group/monfh/message/10191>

^{ix} <http://freebmd.rootsweb.com>

^x Post Office Directory of Monmouthshire & South Wales, 1871, via www.historicaldirectories.org

^{xi} www.familysearch.org, 1881 Wales Census, Source Information: Dwelling Cwm Coulan, Census Place Llanellen, Monmouth, Wales, Family History Library Film 1342260, Public Records Office Reference RG11, Piece / Folio 5236 / 44, Page Number 6

^{xii} Monmouth Yahoo Newsgroup, <http://groups.yahoo.com/group/monfh/message/10191>

^{xiii} www.ancestry.com, 1891 Wales Census, RG12/4348, Llanellen, Abergavenny, ED 18, Folio 100, Page 7,

GSU

^{xiv} www.ancestry.com, 1901 Wales Census, RG13/4930, Llanellen, Abergavenny, Ilanvihangel, ED 18, Folio 117, Page 8, Household schedule #50

^{xv} <http://freepages.genealogy.rootsweb.com/~familyalbum/Klnellen.htm>

^{xvi} e-mail received 8/27/05, mike john [mdjohn@ntlworld.com]

^{xvii} <http://www.rootsweb.com/~engcots/CoatesPhotos.html>

^{xviii} <http://www.rootsweb.com/~engcots/Redbrook.html>

^{xix} <http://www.genuki.org.uk/big/eng/GLS/CensusRecords/CGLSarea/coates51.html>,

Permission granted by the Public Record Office on 12 December 1996, to G.W., Beavington to produce transcriptions of Crown Copyright material among census, records held in the P.R.O. , It is hereby acknowledged the following Census material is Crown Copyright and is reproduced with the permission of the Controller of Her Majesty's Stationery Office. Reference 2 CPY (4)19 dated 12 December 1996, P.R.O. Reference # HO 107/1968

^{xx} <http://www.genuki.org.uk/big/eng/GLS/GLSImgMap3.html>

^{xxi} <http://www.data-wales.co.uk/emigl.htm>